

丈量図

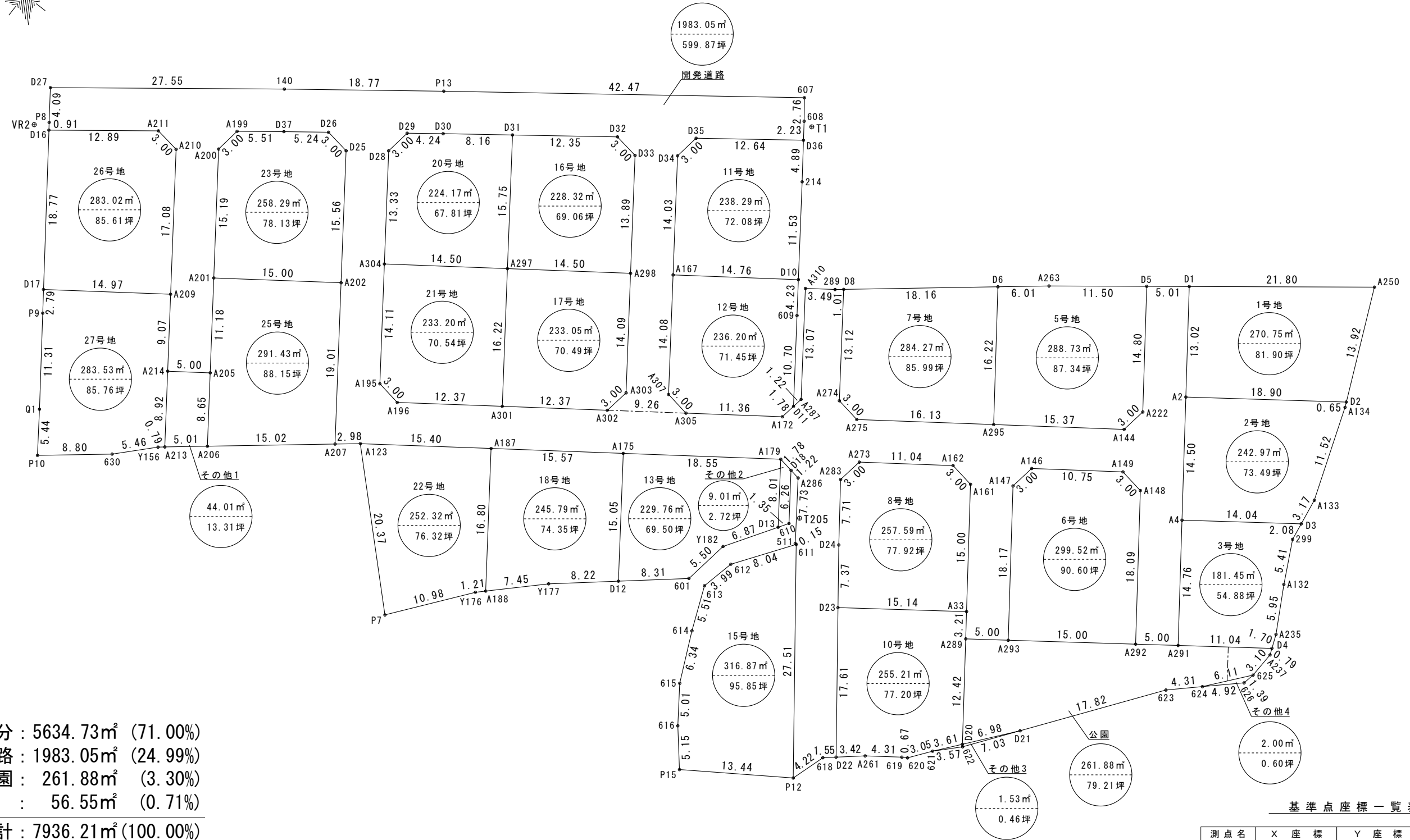
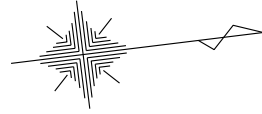

宅地部分 : 5634.73m² (71.00%)
 開発道路 : 1983.05m² (24.99%)
 公園 : 261.88m² (3.30%)
 その他 : 56.55m² (0.71%)
 合計 : 7936.21m² (100.00%)

基準点座標一覧表

測点名	X座標	Y座標	標識
VR2	147133.090	56543.558	鉄(白バット)
T1	147223.943	56554.979	鉄(黄バット)
T205	147216.896	56600.535	鉄(黄バット)

土地の所在	高松市高松町字南谷	縮尺	1 / 500	測量年月日	令和 年 月 日	特記事項	作製者	石井登記測量事務所 土地家屋調査士 石井 敦雄 高松市春日町 1643-9 電話 843-3131
土地の地番	710-1外			図面番号	作製年月日			

座標求積表

Table with 5 columns: 地番, 1号地, 測点, 座標の種類, Xn, Yn, (Xn+1 - Xn-1)Yn. Includes rows for D250, D1, D2, A2, A133, A134.

Table with 5 columns: 地番, 2号地, 測点, 座標の種類, Xn, Yn, (Xn+1 - Xn-1)Yn. Includes rows for D2, A2, A4, D3, A133, A134.

Table with 5 columns: 地番, 3号地, 測点, 座標の種類, Xn, Yn, (Xn+1 - Xn-1)Yn. Includes rows for D3, A4, A291, D4, A235, A132, 299.

Table with 5 columns: 地番, 5号地, 測点, 座標の種類, Xn, Yn, (Xn+1 - Xn-1)Yn. Includes rows for D5, A263, D6, A295, A144, A222.

Table with 5 columns: 地番, 6号地, 測点, 座標の種類, Xn, Yn, (Xn+1 - Xn-1)Yn. Includes rows for A148, A149, A146, A147, A293, A292.

Table with 5 columns: 地番, 7号地, 測点, 座標の種類, Xn, Yn, (Xn+1 - Xn-1)Yn. Includes rows for D6, D8, A274, A275, A295.

Table with 5 columns: 地番, 8号地, 測点, 座標の種類, Xn, Yn, (Xn+1 - Xn-1)Yn. Includes rows for A161, A162, A273, A283, D24, D23, A33.

Table with 5 columns: 地番, 10号地, 測点, 座標の種類, Xn, Yn, (Xn+1 - Xn-1)Yn. Includes rows for A33, D23, D22, A261, 619, 620, 621, D20, A289.

Table with 5 columns: 地番, 11号地, 測点, 座標の種類, Xn, Yn, (Xn+1 - Xn-1)Yn. Includes rows for D36, D35, D34, A167, D10, 214.

Table with 5 columns: 地番, 12号地, 測点, 座標の種類, Xn, Yn, (Xn+1 - Xn-1)Yn. Includes rows for D10, A167, A307, A305, A172, D11, 609.

Table with 5 columns: 地番, 13号地, 測点, 座標の種類, Xn, Yn, (Xn+1 - Xn-1)Yn. Includes rows for A179, A175, D12, 601, Y182, D13.

Table with 5 columns: 地番, 15号地, 測点, 座標の種類, Xn, Yn, (Xn+1 - Xn-1)Yn. Includes rows for 611, 612, 613, 614, 615, 616, P15, P12.

Table with 5 columns: 地番, 16号地, 測点, 座標の種類, Xn, Yn, (Xn+1 - Xn-1)Yn. Includes rows for D33, D32, D31, A297, A298.

Table with 5 columns: 地番, 17号地, 測点, 座標の種類, Xn, Yn, (Xn+1 - Xn-1)Yn. Includes rows for A298, A297, A301, A302, A303.

Table with 5 columns: 地番, 18号地, 測点, 座標の種類, Xn, Yn, (Xn+1 - Xn-1)Yn. Includes rows for A175, A187, A188, Y177, D12.

Table with 5 columns: 地番, 20号地, 測点, 座標の種類, Xn, Yn, (Xn+1 - Xn-1)Yn. Includes rows for D31, D30, D29, D28, A304, A297.

Table with 5 columns: 地番, 21号地, 測点, 座標の種類, Xn, Yn, (Xn+1 - Xn-1)Yn. Includes rows for A297, A304, A195, A196, A301.

Table with 5 columns: 地番, 22号地, 測点, 座標の種類, Xn, Yn, (Xn+1 - Xn-1)Yn. Includes rows for A187, A123, P7, Y176, A188.

Table with 5 columns: 地番, 23号地, 測点, 座標の種類, Xn, Yn, (Xn+1 - Xn-1)Yn. Includes rows for D25, D26, D37, A199, A200, A201, A202.

Table with 5 columns: 地番, 25号地, 測点, 座標の種類, Xn, Yn, (Xn+1 - Xn-1)Yn. Includes rows for A202, A201, A205, A206, A207.

Table with 5 columns: 地番, 26号地, 測点, 座標の種類, Xn, Yn, (Xn+1 - Xn-1)Yn. Includes rows for A210, A211, D16, D17, A209.

Table with 5 columns: 地番, 27号地, 測点, 座標の種類, Xn, Yn, (Xn+1 - Xn-1)Yn. Includes rows for A209, D17, P9, Q1, P10, 630, Y156, A213, A214.

Table with 5 columns: 地番, その他1, 測点, 座標の種類, Xn, Yn, (Xn+1 - Xn-1)Yn. Includes rows for A205, A214, A213, A206.

Table with 5 columns: 地番, その他2, 測点, 座標の種類, Xn, Yn, (Xn+1 - Xn-1)Yn. Includes rows for D18, A179, D13, 610.

Table with 5 columns: 地番, その他3, 測点, 座標の種類, Xn, Yn, (Xn+1 - Xn-1)Yn. Includes rows for D21, D20, 621, 622.

Table with 5 columns: 地番, その他4, 測点, 座標の種類, Xn, Yn, (Xn+1 - Xn-1)Yn. Includes rows for 625, 624, 626.

Table with 5 columns: 地番, 公園, 測点, 座標の種類, Xn, Yn, (Xn+1 - Xn-1)Yn. Includes rows for D4, A291, A292, A293, A289, D20, D21, 623, 624, 625, A237.

Table with 5 columns: 地番, 開発道路, 測点, 座標の種類, Xn, Yn, (Xn+1 - Xn-1)Yn. Includes rows for D1, D5, A222, A144, A295, A275, A274, D8, 289, A310, A287, D11, A172, A305, A302, A301, A196, A195, A304, D28, D29, D30, D31, D32, D33, A298, A303, A302, A305, A307, A167, D34, D35, D36, 608, 607, P13, I40, D27, P8, D16, A211, A210, A209, A214, A205, A201, A200, A199, D37, D26, D25, A202, A207, A123, A187, A175, A179, D18, A286, 511, 611, P12, 618, D22, D23, D24, A283, A273, A162, A161, A33, A289, A293, A146, A149, A148, A292, A291, A4, A2.

Form with fields for 土地の所在 (高松市高松町字南谷), 縮尺 (1/500), 測量年月日 (令和 年 月 日), 作製年月日 (令和 年 月 日), 特記事項, 土地の地番 (710-1外), 作製者 (石井登記測量事務所 石井敦雄), 土地家屋調査士 (石井敦雄), 高松市春日町 (1643-9), 電話 (843-3131).