

# 実測図 S=1:400

## アイタウン下田井Ⅱ

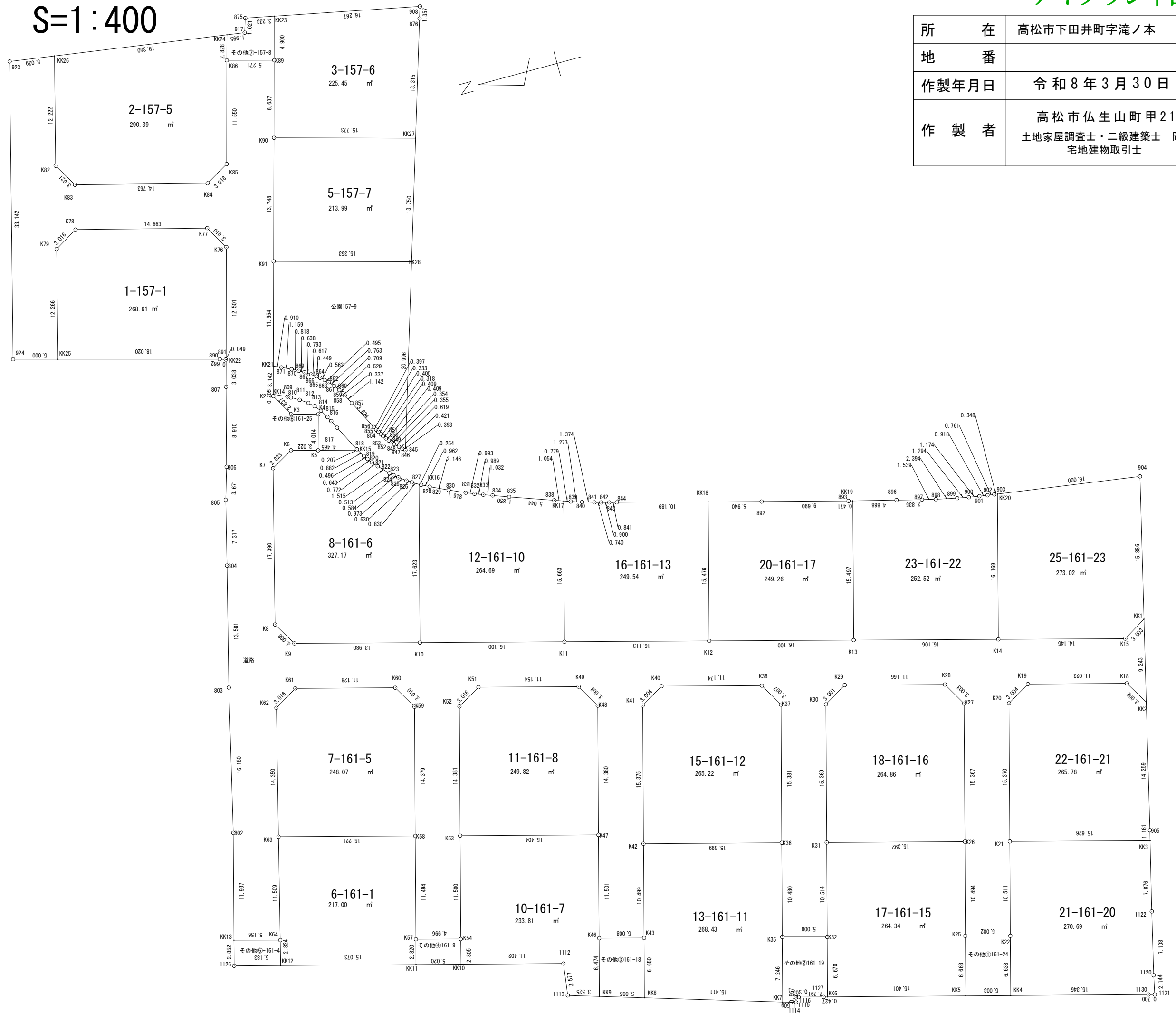

所在	高松市下田井町字滝ノ本
地番	
作製年月日	令和8年3月30日
作製者	高松市仏生山町甲2130-1 土地家屋調査士・二級建築士 岡野上竜二 (岡野上)

求積表

地番 B 1-157-1					
NO	Xn	Yn	Yn+1-Yn-1	Xn・(Yn+1-Yn-1)	
KK25	144138.253	55122.539	16.577	2389379.819981	
K79	144135.195	55134.418	13.415	1933573.640925	
K78	144132.600	55135.954	-2.132	-307290.703200	
K77	144118.403	55132.286	-6.271	-903766.505213	
K76	144116.891	55129.683	-14.664	-2113330.089624	
KK22	144120.226	55117.638	-12.045	-1735927.568100	
891	144120.226	55117.638	0.219	31562.329494	
890	144120.856	55117.841	4.901	706336.315256	
			合計	537.239519	
			合計面積	268.6197595	
			地積	268.61	

地番 C 2-157-5					
NO	Xn	Yn	Yn+1-Yn-1	Xn・(Yn+1-Yn-1)	
K83	144131.354	55140.785	6.295	907306.873430	
K82	144132.884	55143.390	14.438	2080990.579192	
KK26	144129.825	55155.223	9.091	1310284.239075	
KK24	144110.670	55152.481	-5.470	-788285.364900	
K86	144111.417	55149.753	-13.873	-1999257.688041	
K85	144114.449	55138.608	-12.658	-1824200.695442	
K84	144117.060	55137.095	2.177	313742.839620	
			合計	580.782934	
			合計面積	290.3914670	
			地積	290.39	

地番 D 3-157-6					
NO	Xn	Yn	Yn+1-Yn-1	Xn・(Yn+1-Yn-1)	
K90	144108.598	55140.050	12.487	1799484.063226	
K89	144106.327	55148.383	13.062	1882316.843274	
KK23	144105.042	55153.112	1.543	223254.079806	
908	144089.090	55149.926	-4.482	-645807.301380	
876	144089.491	55148.630	-14.030	-2021575.558730	
KK27	144093.382	55135.896	-8.580	-1236321.217560	
			合計	450.908636	
			合計面積	225.4543180	
			地積	225.45	

地番 E 5-157-7					
NO	Xn	Yn	Yn+1-Yn-1	Xn・(Yn+1-Yn-1)	
K91	144112.222	55126.788	17.304	2493717.889488	
K90	144108.598	55140.050	9.108	1312541.110584	
KK27	144093.382	55135.896	-17.304	-2493991.882128	
KK28	144097.400	55122.746	-9.108	-1312439.119200	
			合計	427.998744	
			合計面積	213.9993720	
			地積	213.99	

地番 F 6-161-1					
NO	Xn	Yn	Yn+1-Yn-1	Xn・(Yn+1-Yn-1)	
KK12	144131.916	55050.937	6.572	947234.951952	
K64	144131.224	55053.675	13.897	2002991.619928	
K63	144128.408	55064.834	7.270	1047813.526160	
K58	144113.692	55060.945	-15.006	-2162570.062152	
K57	144116.613	55049.828	-13.842	-1994862.157146	
KK11	144117.339	55047.103	1.109	159826.128951	
			合計	434.007693	
			合計面積	217.0038465	
			地積	217.00	

地番 G 7-161-5					
NO	Xn	Yn	Yn+1-Yn-1	Xn・(Yn+1-Yn-1)	
K63	144128.408	55064.834	17.801	2565629.790808	
K62	144124.889	55078.746	15.445	2226008.910605	
K61	144122.292	55080.279	-1.302	-187647.224184	
K60	144111.531	55077.444	-5.434	-783102.059454	
K59	144110.012	55074.845	-16.499	-2377671.087988	
K58	144113.692	55060.945	-10.011	-1442722.170612	
			合計	496.159175	
			合計面積	248.0795875	
			地積	248.07	

地番 H 8-161-6					
NO	Xn	Yn	Yn+1-Yn-1	Xn・(Yn+1-Yn-1)	
K7	144118.289	55104.572	18.251	2630302.892539	
K6	144115.842	55105.980	0.611	88054.779462	
K5	144112.927	55105.183	-1.982	-285631.821314	
KK15	144108.622	55103.998	-1.938	-279282.509436	
819	144108.163	55103.245	-1.161	-167309.577243	
820	144107.881	55102.837	-0.918	-132291.034758	
821	144107.494	55102.327	-1.095	-157797.705930	
822	144106.991	55101.742	-1.665	-239938.140015	
823	144105.929	55100.662	-1.420	-204630.419180	
824	144105.545	55100.322	-0.708	-102026.725860	
825	144105.092	55099.954	-0.952	-137188.047584	
826	144104.314	55099.370	-0.924	-133152.386136	
827	144103.784	55099.030	-0.760	-109518.875840	
KK16	144103.068	55098.610	-17.458	-2515751.361144	
K10	144107.571	55081.572	-13.472	-1941417.196512	
K9	144121.089	55085.138	6.157	887353.544973	
K8	144122.617	55087.729	19.434	2800878.938778	
			合計	654.354800	
			合計面積	327.1774000	
			地積	327.17	

地番 I 10-161-7					
NO	Xn	Yn	Yn+1-Yn-1	Xn・(Yn+1-Yn-1)	
K54	144111.785	55048.543	13.837	1994074.769045	
K53	144108.853	55059.663	7.191	1036286.761923	
K47	144093.958	55055.734	-15.050	-2168614.067900	
K46	144096.889	55044.613	-17.380	-2504403.930820	
KK9	144098.545	55038.354	-5.234	-794211.784530	
1113	144101.918	55039.379	4.572	658833.969096	
1112	144101.457	55042.926	6.447	929022.093279	
KK10	144112.484	55045.826	5.617	809479.822628	
			合計	467.632721	
			合計面積	233.8163605	
			地積	233.81	

地番 J 11-161-8					
NO	Xn	Yn	Yn+1-Yn-1	Xn・(Yn+1-Yn-1)	
K53	144108.853	55059.663	17.832	2569749.066696	
K52	144105.178	55073.566	15.419	2221957.739582	
K51	144102.571	55075.082	-1.332	-191944.624572	
K49	144091.787	55072.234	-5.446	-784723.872002	
K48	144090.280	55069.636	-16.500	-2377489.620000	
K47	144093.958	55055.734	-9.973	-1437409.043134	
			合計	499.646570	
			合計面積	249.8232850	
			地積	249.82	

地番 K 12-161-10					
NO	Xn	Yn	Yn+1-Yn-1	Xn・(Yn+1-Yn-1)	
K10	144107.571	55081.572	21.141	3046578.158511	
KK16	144103.068	55098.610	16.910	2436782.879880	
828	144102.849	55098.482	-0.567	-81706.315383	
829	144101.993	55098.043	-1.350	-194537.690550	
830	144100.050	55097.132	-1.691	-243673.184550	
831	144098.298	55096.352	-1.154	-166289.435892	
832	144097.378	55095.978	-0.728	-104902.891184	
833	144096.455	55095.624	-0.702	-101155.711410	
834	144095.483	55095.276	-0.988	-142366.337204	
835	144093.747	55094.636	-2.317	-333865.211799	
838	144088.990	55092.959	-2.025	-291780.204750	
KK17	144087.995	55092.611	-15.490	-2231923.042550	
K11	144092.003	55077.469	-11.039	-1590631.621117	
			合計	529.392002	
			合計面積	264.6960010	
			地積	264.69	

地番 L 13-161-11					
NO	Xn	Yn	Yn+1-Yn-1	Xn・(Yn+1-Yn-1)	
K43	144092.049	55043.326	16.579	2388902.080371	
K42	144089.372	55053.478	6.231	897820.876932	
K36	144074.481	55049.557	-14.052	-2024534.607012	
K35	144077.162	55039.426	-17.137	-2469050.325194	
KK7	144079.010	55032.420	-2.527	-364087.658270	
KK8	144093.756	55036.899	10.906	1571486.502936	
			合計	536.869763	
			合計面積	268.4348815	
			地積	268.43	

地番 M 15-161-12					
NO	Xn	Yn	Yn+1-Yn-1	Xn・(Yn+1-Yn-1)	
K42	144089.372	55053.478	18.787	2707007.031764	
K41	144085.448	55068.344	16.395	2362280.919960	
K40	144082.862	55069.873	-1.322	-190477.543564	
K38	144072.058	55067.022	-5.448	-784904.571984	
K37	144070.543	55064.425	-17.465	-2516192.033495	
K36	144074.481	55049.557	-10.947	-1571783.343507	
			合計	530.459174	
			合計面積	265.2295870	
			地積	265.22	

地番 N 16-161-13					
NO	Xn	Yn	Yn+1-Yn-1	Xn・(Yn+1-Yn-1)	
K11	144092.003	55077.469	19.257	2774779.701771	
KK17	144087.995	55092.611	14.885	2144749.805575	
839	144087.260	55092.354	-0.651	-93800.806260	
840	144086.045	55091.960	-0.784	-112963.459280	
841	144084.728	55091.570	-0.588	-84721.820064	
842	144084.015	55091.372	-0.434	-62532.462510	
843	144083.146	55091.136	-0.446	-64261.083116	
844	144082.332	55090.926	-2.816	-405735.846912	
KK18	144072.482	55088.320	-17.572	-2531641.653704	
K12	144076.424	55073.354	-10.851	-1563373.276824	
			合計	499.098676	
			合計面積	249.5493380	
			地積	249.54	

地番 O 17-161-15					
NO	Xn	Yn	Yn+1-Yn-1	Xn・(Yn+1-Yn-1)	
KK6	144074.037	55031.671	10.355	1491886.653135	
K32	144072.328	55038.118	16.612	2393329.512736	
K31	144069.642	55048.283	6.238	898706.426796	
K26	144054.759	55044.356	-14.072	-2027138.568648	
K25	144057.441	55034.211	-16.593	-2390345.118513	
KK5	144059.140	55027.763	-2.540	-365910.215600	
			合計	528.689906	
			合計面積	264.3449530	
			地積	264.34	

地番 P 18-161-16					
NO	Xn	Yn	Yn+1-Yn-1	Xn・(Yn+1-Yn-1)	
K31	144069.642	55048.283	18.786	2706492.294612	
K30	144065.715	55063.142	16.386	2360660.805990	
K29	144063.131	55064.669	-1.330	-191603.964230	
K28	144052.337	55061.812	-5.456	-785949.550672	
K27	144050.833	55059.213	-17.456	-2514551.340848	
K26	144054.759	55044.356	-10.930	-1574518.151870	
			合計	529.728982	
			合計面積	264.8644910	
			地積	264.86	

地番	W その他①161-24				
NO	Xn	Yn	Yn+1-Yn-1	Xn・(Yn+1-Yn-1)	
K25	144057.441	55032.211	5.150	741895.821150	
K22	144052.610	55032.913	-7.717	-1111653.991370	
KK4	144054.301	55026.494	-5.150	-741879.650150	
KK5	144059.140	55027.763	7.717	1111704.383380	
			合計	66.563010	
			合計面積	33.2815050	
			地積	33.28 m <sup>2</sup>	

地番	X その他②161-19				
NO	Xn	Yn	Yn+1-Yn-1	Xn・(Yn+1-Yn-1)	
KK7	144079.010	55032.420	7.445	1072668.229450	
K35	144077.162	55039.426	5.698	820951.669076	
K32	144072.328	55038.118	-7.755	-1117280.903640	
KK6	144074.037	55031.671	-6.339	-913285.320543	
1127	144074.450	55031.779	0.816	117564.751200	
1116	144077.150	55032.487	0.757	109066.402550	
1115	144077.449	55032.536	-0.506	-72903.189194	
1114	144077.566	55031.981	-0.116	-16712.997656	
			合計	68.641243	
			合計面積	34.3206215	
			地積	34.32 m <sup>2</sup>	

地番	Y その他③161-18				
NO	Xn	Yn	Yn+1-Yn-1	Xn・(Yn+1-Yn-1)	
KK9	144098.545	55038.354	7.714	1111576.176130	
K46	144096.889	55044.613	4.972	716449.732108	
K43	144092.049	55043.326	-7.714	-1111526.065986	
KK8	144093.756	55036.899	-4.972	-716434.154832	
			合計	65.687420	
			合計面積	32.8437100	
			地積	32.84 m <sup>2</sup>	

地番	Z その他④161-9				
NO	Xn	Yn	Yn+1-Yn-1	Xn・(Yn+1-Yn-1)	
KK11	144117.339	55047.103	4.002	576757.590678	
K57	144116.613	55049.828	1.440	207527.922720	
K54	144111.785	55048.543	-4.002	-576735.363570	
KK10	144112.484	55045.826	-1.440	-207521.976960	
			合計	28.172868	
			合計面積	14.0864340	
			地積	14.08 m <sup>2</sup>	

地番	A' その他⑤161-4				
NO	Xn	Yn	Yn+1-Yn-1	Xn・(Yn+1-Yn-1)	
1126	144136.929	55052.255	4.076	587502.122604	
KK13	144136.203	55055.013	1.420	204673.408260	
K64	144131.224	55053.675	-4.076	-587478.869024	
KK12	144131.916	55050.937	-1.420	-204667.320720	
			合計	29.341120	
			合計面積	14.6705600	
			地積	14.67 m <sup>2</sup>	

地番	B' その他⑥161-25				
NO	Xn	Yn	Yn+1-Yn-1	Xn・(Yn+1-Yn-1)	
K2	144116.180	55112.319	2.663	383781.387340	
KK14	144116.124	55112.516	-0.469	-67590.462156	
809	144114.675	55111.850	-0.851	-122641.588425	
810	144114.318	55111.665	-0.697	-100447.679646	
811	144113.441	55111.153	-1.090	-157083.650690	
812	144112.611	55110.575	-1.112	-160253.223432	
813	144112.026	55110.041	-1.211	-174519.663486	
814	144111.480	55109.364	-1.539	-221787.567720	
815	144110.958	55108.502	-1.414	-203772.894612	
816	144110.669	55107.950	-1.424	-205213.592656	
817	144110.236	55107.078	-3.775	-544016.140900	
818	144108.730	55104.175	-3.080	-443854.888400	
KK15	144108.622	55103.998	1.008	145261.490976	
K5	144112.927	55105.183	5.057	728779.071839	
K4	144111.869	55109.055	4.670	673002.428230	
K3	144114.777	55109.853	3.264	470390.632128	
			合計	33.658390	
			合計面積	16.8291950	
			地積	16.82 m <sup>2</sup>	

地番	C' その他⑦157-8				
NO	Xn	Yn	Yn+1-Yn-1	Xn・(Yn+1-Yn-1)	
K86	144111.417	55149.753	4.098	590568.586866	
KK24	144110.670	55152.481	2.445	352350.588150	
917	144108.695	55152.198	1.264	182153.390480	
875	144108.212	55153.745	0.914	131714.905768	
KK23	144105.042	55153.112	-5.362	-772691.235204	
K89	144106.327	55148.383	-3.359	-484053.152393	
			合計	43.083667	
			合計面積	21.5418335	
			地積	21.54 m <sup>2</sup>	

地番	A 道路				
NO	Xn	Yn	Yn+1-Yn-1	Xn・(Yn+1-Yn-1)	
KK2	144031.204	55054.071	-6.411	-923384.048844	
K18	144032.746	55056.647	5.382	775184.238972	
K19	144043.406	55059.453	1.288	185527.906928	
K20	144045.998	55057.935	-16.378	-2359185.355244	
K21	144049.923	55043.075	-25.022	-3604417.173306	
K22	144052.610	55032.913	-8.864	-1276882.335040	
K25	144057.441	55034.211	11.443	1648449.297363	
K26	144054.759	55044.356	25.002	3601657.084518	
K27	144050.833	55059.213	17.456	2514551.340848	
K28	144052.337	55061.812	5.456	785949.550672	
K29	144063.131	55064.869	1.330	191603.964230	
K30	144065.715	55063.142	-16.386	-2360660.805990	
K31	144069.642	55048.283	-25.024	-3605198.721408	
K32	144072.328	55038.118	-8.857	-1276048.609096	
K35	144077.162	55039.426	11.439	1648098.656118	
K36	144074.481	55049.557	24.999	3601717.950519	
K37	144070.543	55064.425	17.465	2516192.033495	
K38	144072.058	55067.022	5.448	784904.571984	
K40	144082.862	55069.873	1.322	190477.543564	
K41	144085.448	55068.344	-16.395	-2362280.919960	
K42	144089.372	55053.478	-25.018	-3604827.906696	
K43	144092.049	55043.326	-8.865	-1277376.014385	
K46	144096.889	55044.613	12.408	1787954.198712	
K47	144093.958	55055.734	25.023	3605663.111034	
K48	144090.280	55069.636	16.500	2377489.620000	
K49	144091.787	55072.234	5.446	784723.872002	
K51	144102.571	55075.082	1.332	191944.624572	
K52	144105.178	55073.566	-15.419	-2221957.739582	
K53	144108.853	55059.663	-25.023	-3606035.828619	
K54	144111.785	55048.543	-9.835	-1417339.405475	
K57	144116.613	55049.828	12.402	1787334.234426	
K58	144113.692	55060.945	25.017	3605292.232764	
K59	144110.012	55074.845	16.499	2377671.087988	
K60	144111.531	55077.444	5.434	783102.059454	
K61	144122.292	55080.279	1.302	187647.224184	
K62	144124.889	55078.746	-15.445	-2226008.910605	
K63	144128.408	55064.834	-25.071	-3613443.316968	
K64	144131.224	55053.675	-9.821	-1415512.750904	
KK13	144136.203	55055.013	12.882	1856762.567046	
802	144133.166	55066.557	27.284	3932529.301144	
803	144129.420	55082.297	28.901	4165484.367420	
804	144126.070	55095.458	20.259	2919850.052130	
805	144124.295	55102.556	10.616	1530023.515720	
806	144123.245	55106.074	12.136	1749079.701320	
807	144120.984	55114.692	11.548	1664309.123232	
KK22	144120.180	55117.622	14.991	2160505.618380	
K76	144116.891	55129.683	14.664	2113330.089624	
K77	144118.403	55132.286	6.271	903766.505213	
K78	144132.600	55135.954	2.132	307290.703200	
K79	144135.195	55134.418	-13.415	-1933573.640925	
KK25	144138.253	55122.539	-10.575	-1524262.025475	
924	144143.080	55123.843	33.396	4813802.299680	
923	144134.803	55155.935	31.380	4522950.118140	
KK26	144129.825	55155.223	-12.545	-1808108.654625	
K82	144132.884	55143.390	-14.438	-2080990.579192	
K83	144131.354	55140.785	-6.295	-907306.873430	
K84	144117.060	55137.095	-2.177	-313742.839620	
K85	144114.449	55138.608	12.658	1824200.695442	
K86	144111.417	55149.753	9.775	1408689.101175	
K89	144106.327	55148.383	-9.703	-1398263.690881	
K90	144108.598	55140.050	-21.595	-3112025.173810	
K91	144112.222	55126.788	-24.504	-3531325.887888	
KK21	144115.294	55115.546	-14.272	-2056813.475968	
KK14	144116.124	55112.516	-3.227	-465062.732148	
K2	144116.180	55112.319	-2.663	-383781.387340	
K3	144114.777	55109.853	-3.264	-470390.632128	
K4	144111.869	55109.055	-4.670	-673002.428230	
K5	144112.927	55105.183	-3.075	-443147.250525	
K6	144115.842	55105.980	-0.611	-88054.779462	
K7	144118.289	55104.572	-18.251	-2630302.892539	
K8	144122.617	55087.729	-19.434	-2800878.938778	
K9	144121.089	55085.138	-6.157	-887353.544973	
K10	144107.571	55081.572	-7.669	-1105160.961999	
K11	144092.003	55077.469	-8.218	-1184148.080654	
K12	144076.424	55073.354	-8.232	-1186037.122368	
K13	144060.859	55069.237	-8.237	-1186629.295583	
K14	144045.289	55065.117	-7.731	-1113614.129259	
K15	144031.613	55061.506	-2.059	-296561.091167	
KK1	144029.042	55063.058	-7.435	-1070855.927270	
			合計	3756.282854	
			合計面積	1878.1414270	
			地積	1878.14 m <sup>2</sup>	